

**Indesit** Company

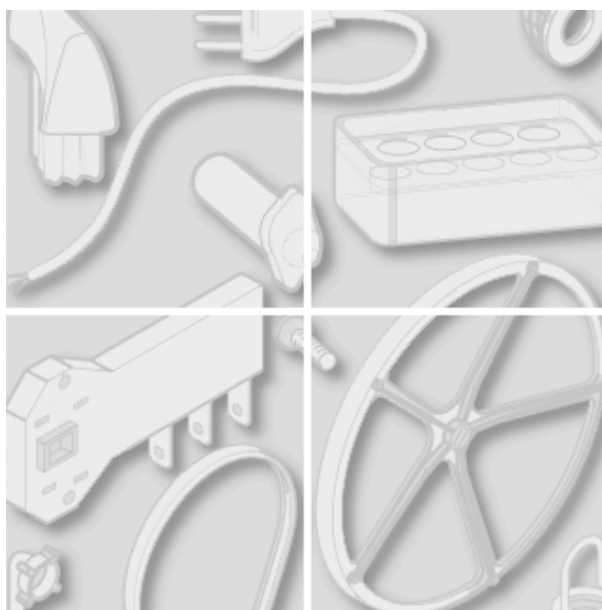

Model type:  
**B34FNFSP**

Commercial code:  
**28909**

## General notes

### Technical Documentation guidelines

---



---

You can find herewith some generic information to simplify consulting of technical documentation:

1. Models of same range share the same exploded views, which report the richest set of spare parts: generally, a model does not necessarily have a related spare part for each particular shown on exploded views.
2. Some spare parts can not be represented directly on the exploded views (instruction booklets, specific kit, etc...). You can find those codes in the spare parts list with the same reference of particular where spares are installed or with references 099, 999. Instruction booklets, once managed, appear with 000 reference.
3. On the higher right site of each exploded view there is a serial number which indicates the beginning of the production of certain range: some models might have more than an exploded view for a given category, each distinguished by a different serial no. and linked to another spare parts list. In this case, serial no. is required to supply the right spare part code. Exploded view to be considered is the one with a more recent serial no. but previous than the one of the model that needs assistance.
4. Exploded views might require further updates even after publishing. Addition of new spares will go on following the already existing numeration references. Revision number of an exploded view is shown into last four digits of serial number into upper right hand corner.
5. The spare parts list associated to an exploded view shows related codes of spares managed for a certain model; for each spare part other informations are available:  
  
REF: reference no of spare into a table; SUBSTITUTE: list of spare(s) which can replace a code but that keeps same functional characteristics  
  
INDUSTRIAL CODE: list of variables of a model (shown into model label) where such spare is used; NOTICE: code of information(s) to refer to complete technical intervention, track for changes or to find correct spare part code.
6. Some notices, into a same section are generic therefore cannot be directly linked to a spare part. In order to assist a model in the best way as possible, it is helpful to pay attention to all notices and constantly verify documentation updates
7. Technical documentation cover shows model name and its commercial codes

51520d0

Exploded views

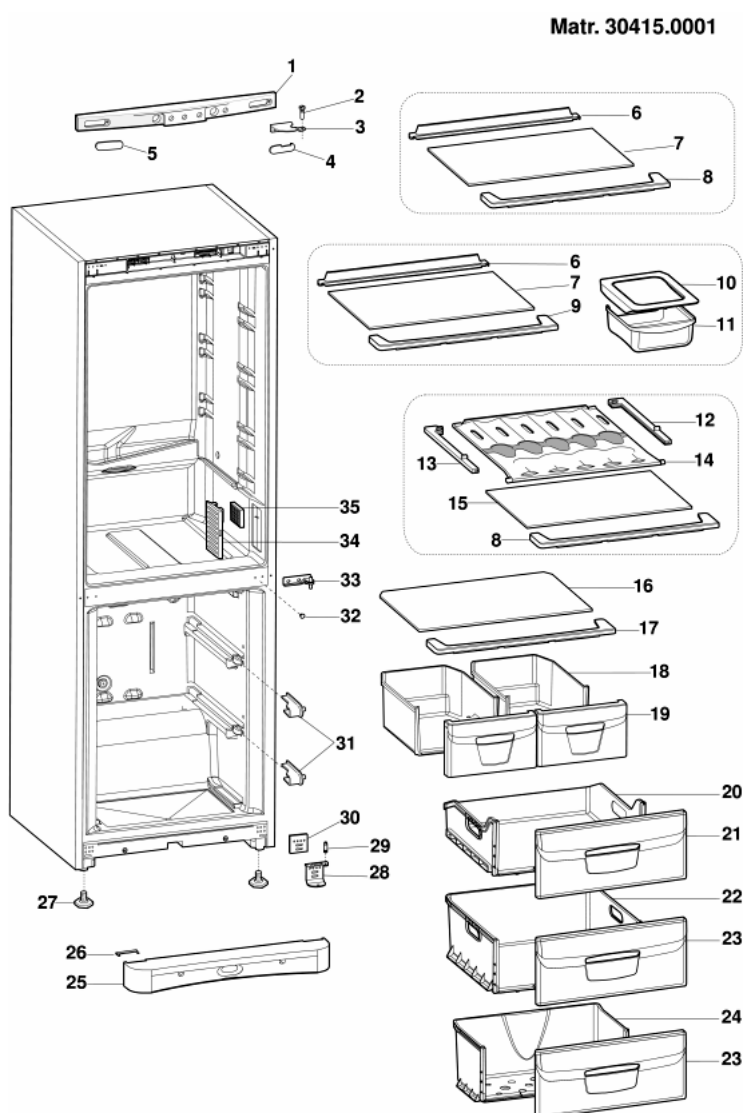

51520d0

Spare parts list

Ref.	Code	Substitute	Description	Notice	Industrial code
000	C00094739		instruction booklet uk-d-es-i-pt		
000	C00109710		instruction booklet ro-sl-sb-gr		93289090201
000	C00115755		instruction booklet (nl) ba34fnf(sp)		93289090301
001	C00094384	1 x C00115426	control panel-top		93289090000,9328909
001	C00115426		control panel-top		
002	C00075565		hinge pin - m8x3 (18+2,5)		
003	C00081644		upper hinge (m8) lh-rh cromed		
004	C00075561	1 x C00114603	hinge surround (74x20) - white		93289090000,9328909
004	C00114603		hinge surround (74x20) - polar white		
005	C00075562	1 x C00114601	blanking plug (74x20) - white		93289090000,9328909
005	C00114601		blanking plug (74x20) - polar white		
006	C00094447		back glass section w.497 white		
007	C00094449		glass shelf 493x336,5x4 indesit		
008	C00094444		front glass section w.530 white		
009	C00094445		front glass section w.530 white		
010	C00094453		chiller cover (wxd) 245x334x31		
011	C00094450		chiller box drawer (240x273x100)		
012	C00094735		guide (right) play zone white		
013	C00094736		guide (left) play zone white		
014	C00094732		shelf play zone blue 496/471x306		
015	C00094726		glass shelf 493x336,5x4 play zone		
016	C00094691		crisper cover (499x334x4 2x450)		
017	C00094432		trim - glass crisper cover		
018	C00075590	2 x C00096115	crisper box (wxhxd 246x137x354) -		
019	C00094433		panel crisper box wxh 246x160 light		
020	C00094442		upper drawer -(wxd 444x398) -		
021	C00094718		panel drawer - wxh 440x197 (light		
022	C00075593		middle drawer -(wxdxh		
023	C00094439		panel drawer - wxh 440x197 (light		
024	C00075594		lower drawer - white wxdxh		
025	C00094949	1 x C00114623	front base moulding indesit3 white		93289090000,9328909
025	C00114623		front base moulding indesit polar-		
026	C00094381	1 x C00114621	white base cap 58x18x4mm		93289090000,9328909
026	C00114621		base cap 58x18x4mm polar white		
027	C00053419		foot 17,7x37,5 adjustable		

51520d0

Spare parts list

Ref.	Code	Substitute	Description	Notice	Industrial code
028	C00076614		lower hinge assy(m6) rh-lh -		
029	C00017658		hinge pin m6x13,5		
030	C00075566		packing - lower hinge 30x40 (6		
031	C00075596		evap.fixing plastic right		
031	C00075597		evap.fixing plastic left(tos)		
032	C00011286	1 x C00114785	blanking plug d4,5x8mm - white		93289090000,9328909
032	C00114785		blanking plug d4,5x8mm -		
033	C00053478	1 x C00114624	central hinge - white 'df245x bom.		93289090000,9328909
033	C00114624		central hinge - polar white		
034	C00094429		cover air return rh white		

51521e0

Exploded views

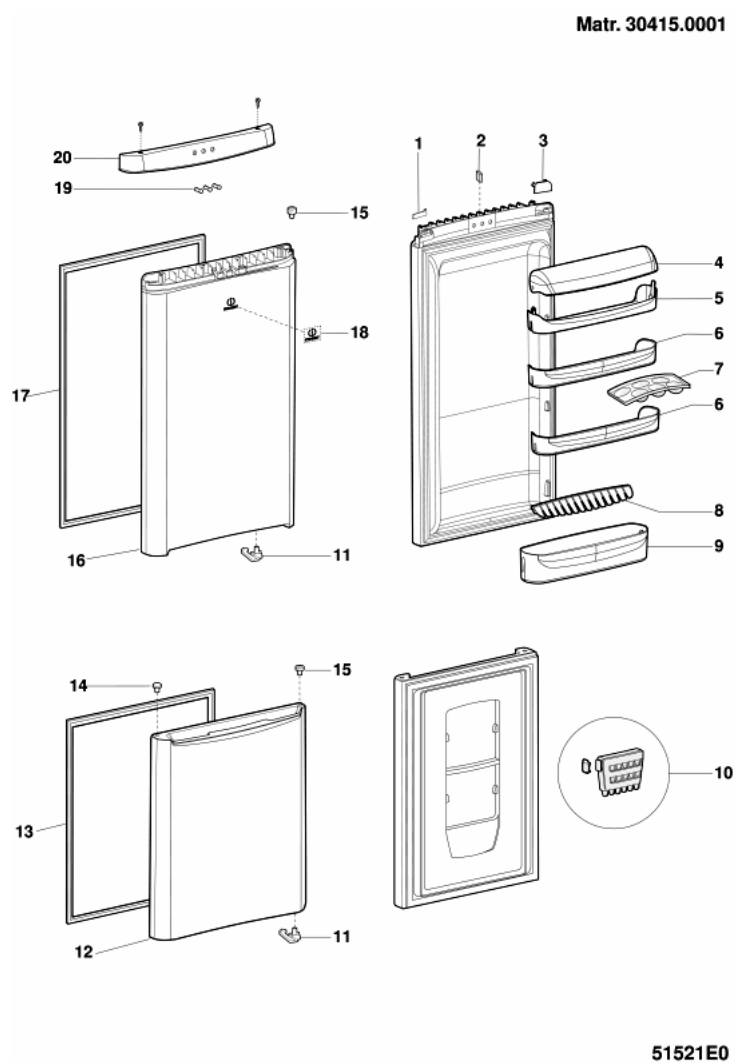

51521e0

Spare parts list

Ref.	Code	Substitute	Description	Notice	Industrial code
002	C00075612		magnetic switch (door stop) 15x10x5		
003	C00081839	1 x C00114649	hinge surround lh 66x27 - white		93289090000,9328909
003	C00114649		hinge surround lh 66x27 - pw upper		
004	C00094417		eggs compart. door blue		
005	C00094416		shelf eggs wxh 486x64x112 (light		
006	C00094415		central shelf wxh 486x6x112 (light		
007	C00076539	1 x C00114690	eggs tray (6) - white		
008	C00081955	1 x C00114685	shelf trim rail (423x39) white		
009	C00094410		bottle shelf 486x104x135 light blue		
010	C00075560		ice cubes container (indesit00)		
011	C00082900	1 x C00114650	door stop bush lh - white 49ø		93289090000,9328909
011	C00082901	1 x C00114651	door stop bush rh - white 49ø		93289090000,9328909
011	C00114650		door stop bush lh - polar white 49ø		
011	C00114651		door stop bush rh - polar white 49ø		
012	C00094367	1 x C00115485	freezer door assy 592x713x87 white		93289090000,9328909
012	C00115485		freezer door assy 592x713x87		
013	C00075531	1 x C00115566	freezer door gasket (554x682) white		93289090000,9328909
013	C00115566		freezer door gasket (554x682)		
014	C00045903	1 x C00114784	blanking plug (h.14 d.13,8/9,5) -		93289090000,9328909
014	C00114784		blanking plug (h.14 d.13,8/9,5) -		
015	C00022161		hinge bush 4x15 mm - white		
015	C00040969		door bush (2,5mm) - white		
016	C00094738	1 x C00115471	fridge door 592x1137x103- white		93289090000,9328909
016	C00115471		fridge door 592x1137x103- polarw		
017	C00076126	1 x C00115396	freezer door gasket (554x1051)		93289090000,9328909
017	C00115396		freezer door gasket (554x1051)		
018	C00094380		logo indesit chromed		
019	C00094386	1 x C00115501	indicator light white(indesit-03)		93289090000,9328909
019	C00115501		indicator light polarwh (indesit-03)		
020	C00094387	1 x C00115418	control cover (door top) 5930x54-		93289090000,9328909
020	C00115418		control cover (door top) 594x54-		

51522e0

Exploded views

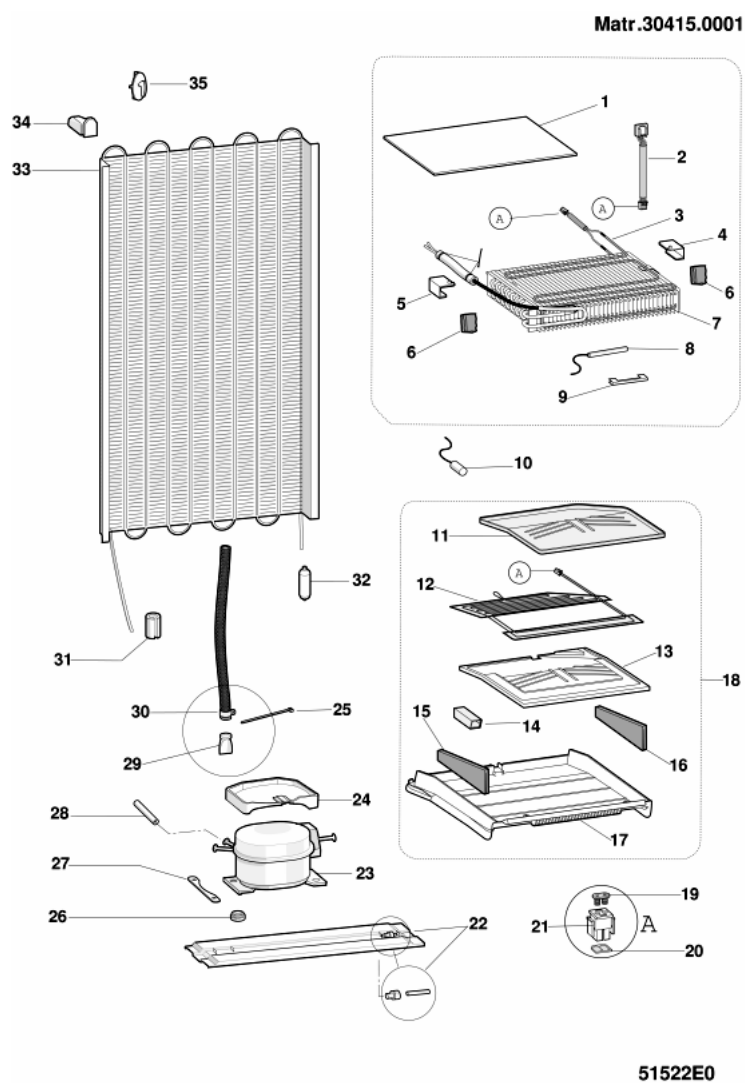



51522e0

Spare parts list

Ref.	Code	Substitute	Description	Notice	Industrial code
002	C00094665		fuse-m tf0410012 72°c 220v(amp		
003	C00094663		no-frost evap.resis.140w 240v (amp)		
004	C00094498		evaporator-nf back fixing plastic		
005	C00094500		evaporator-nf back fixing plastic left		
006	C00094463		evaporator sponge seal (41x43x25)		
007	C00094667	1 x C00113845	set freezer evaporator nofrost r600	n1030085	
007	C00113845		set freezer evaporator nofrost r600		
009	C00059949		retainer - probe bulb sensor		
012	C00094469		defrosting gutter resist. 47,6w 240v	n1030069	
014	C00094472		defrost water raceway w.73x25x23		
015	C00094468		separator sponge seal lh	n1030068	
016	C00094467		separator sponge seal rh (250x26)	n1030068	
018	C00094485	1 x C00097661	set shell freezer separator no frost	n1030069	
022	C00013997		mounting channel 586mm -		
023	C00094402	1 x C00054788 1 x C00099146	compr. htk12aa 220-240/50 1/4hp-		93289090000,9328909
023	C00099146		compres. danf. nle13kk3 220-		93289090101,9328909
024	C00054788		defrost water tray - (plastic) danfoss		93289090101,9328909
024	C00094407		defrost water tray zanussi (nf)		93289090000,9328909
025	C00032492		fixing-clamp fastex (2007691100)		
026	C00032453		rubber shock absorber - compressor		
027	C00008471		fixing plate - compressor (750908)		
028	C00043021		service pipe with valve (6 nfmssv)		
029	C00028100		non return valve - defrost water		
030	C00095021		connector - defrost pipe/non return		
032	C00045265		filter gr.12 (d.1,95/d.4 mm) gas		
033	C00023282		condenser h=1000+200x591		
034	C00015332		spacer - condenser		
035	C00094418		stop mains supply cable		

5152330

Exploded views

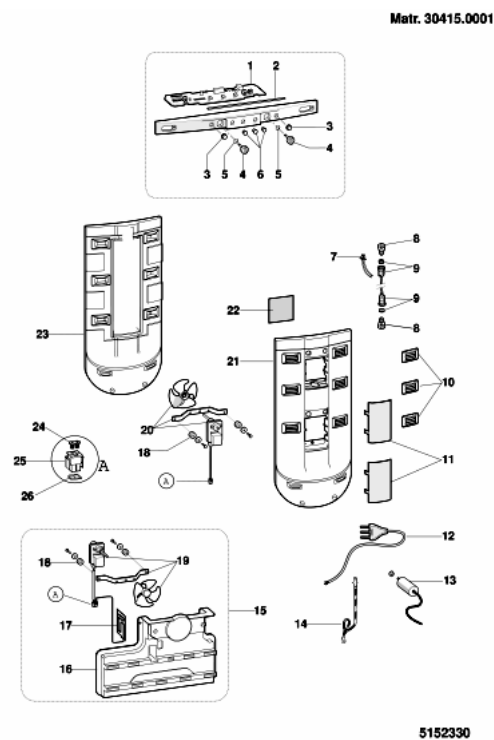

5152330

Spare parts list

Ref.	Code	Substitute	Description	Notice	Industrial code
001	C00094383		card micropr. (magnetek	n1030060, n1030068	
002	C00094202		sponge(350x8x8)		
003	C00059919	1 x C00115574	buttons cover white (h=5,5 mm)		93289090000,9328909
003	C00115574		buttons cover polarwh (h=5,5 mm)		
004	C00075604	1 x C00175020	trimmer knob white (c238)		93289090000,9328909
004	C00115431		trimmer knob polarwhite		
005	C00064775		gasket oring dia=11/8 mm		93289090000,9328909
006	C00059921		lens (indicator light)		
007	C00094688		fridge wiring-amp lamp bulb		
008	C00060617		lamp bulb 10w (e14)		
009	C00094952		lamp-socket (vossloh) 250v e14 kit		
011	C00174888		lamp cover-fridge		
012	C00008598		mains supply cable 3x0,75		
013	C00090222		starting capacitor 4mf (ducati)		
015	C00094490		set air conveyor nofrost-60	n1030067, n1030068	
017	C00095014		set fan-motor/defrost heater kit		
018	C00046806		rubber anti shock bush - fan motor		
020	C00094660		fan-motor f6410 220v 3,5w(amp-		
021	C00094737	1 x C00111030	multi-flow cover l70 arst(kit)	n1030068	
021	C00111030	1 x C00117071	multi-flow cover l70 arst(kit) white-		
022	C00094669		light deflection folio (80x100x0,1)		

## Notices

### n1025093: Doors / weather stripping combined fridges / freezers Indesit/2000 Melano and Setubal

With the exception of the model R45, width 700 mm produced in Turkey (Manisa), on all the combined fridge and freezer models in the Indesit (range 2000), width 600 mm produced in Italy (Melano) and in Portugal (Setubal), Poland (Lodowek) the doors handled as replacement are without weather stripping because this is no longer blocked between door and counter-door. The weather stripping has a new profile and is located in the housing resulting along the external perimeter of the counter-door, where it is threaded through by simple hand pressure. To remove the weather stripping it will suffice to unthread it from its housing without any other operation.

Therefore in case of replacement of the door the weather stripping may be recovered from the existing door, however the weather strips are handled singularly as a spare part.

### n1030020: Replacement of NTC sensors on latest generation of "cold product line" models

(KRF 310VE - KRF330VE - KRF310VNFE - KRF330VNFE), including the new combo appliances in the Indesit-2000 range (C238 e C240), Ariston-2001 (MBA3831-4031- 4231 ; MBA3841 - 4041) on static or no-frost "cold product line" models of the latest generation electronic version, the NTC sensors cannot be replaced because they are blocked within the cabinet. This decision is due to the low faultiness of the component and to the high guarantees of operation in foam-insulated environments.

The exceptions to the aforementioned are the upright Ariston electronic 600 mm wide freezers, rounded aesthetics, Ariston models EUP300XEU - EUP350XEU - TUP300XOM (including deriving versions) where the sensor can still be replaced in the event of a fault.

Where the replacement of the product is deemed necessary by the probe defect, then it is important to closely check that the problem is determined by the probe and not by the electronic card.

In order to check the correct operation of the probe it is possible to measure the resistance of the wiring harness terminals that must present the following values :

- temperature of + 20 °C = about 2.000 ohm (air probe at environment temperature)
- temperature of + 5 °C = about 7.000 ohm (fridge air probe)
- temperature of - 18 °C = about 23.000 ohm (freezer air probe)

Also, in a less technical manner, replacing each probe on the electronic card (at room temperature) in a "steering" manner, checking the elimination of the problem (if the compressor starts the probe is defective).

N.B. the probes are identifiable by their coloration (marking) placed on the probe and its wiring harness :

- fridge evaporator probe (black marking)
- fridge air probe (brown marking)
- freezer air probe (white marking)
- freezer evaporator probe (no-frost) end of defrost (light blue marking).

#### n1030034: Magnetic switch on combined electronics Ariston-Indesit range - 2000

---

On combined electronic models ( Ariston and Indesit, range 2000 ) on the base of the door's dashboard of refrigerator, there is a magnetic switch assembled (075612) with a rectangular shape that must be inserted on the appropriate hole in the narrow side (the position is compulsory for the stop and the correct function of the product).

The missing of the magnetic switch can cause the following inconvenient with open or closed door:

-If the product has being lit for more than 3 minutes and if magnet is missing, the lamp flashes (if is not broken) as soon as the door opens.

So, in case of substitution of the fridge door, to avoid this inconvenient, together with the dashboard and the moulding, the magnetic switch must always be rescued.

From the end of July the production Dpt. will supply as spare parts the fridge doors of combined electronics, already included with the magnetic switch.

(Anyway please verify always its presence).

#### n1030067: Noisy freezer compartment fan in Ariston and Indesit Opera-60 total no-frost fri

---

On Ariston and Indesit Opera60 Total No Frost fridge-freezers produced before August 2003, the freezer fan may stop due to ice build-up (stalactites), activating the alarm.

The problem has been solved by emptying the conveyor (chamber separator) in the upper part to give the fan more space (see fig.1).

To solve the problem in products in use, an air conveyor kit (Sat code 094490), which also includes modifications to reduce dispersion air flow, has been introduced since 25/9/2003 (see fig.2) and 06/10/2003 (see fig.3).

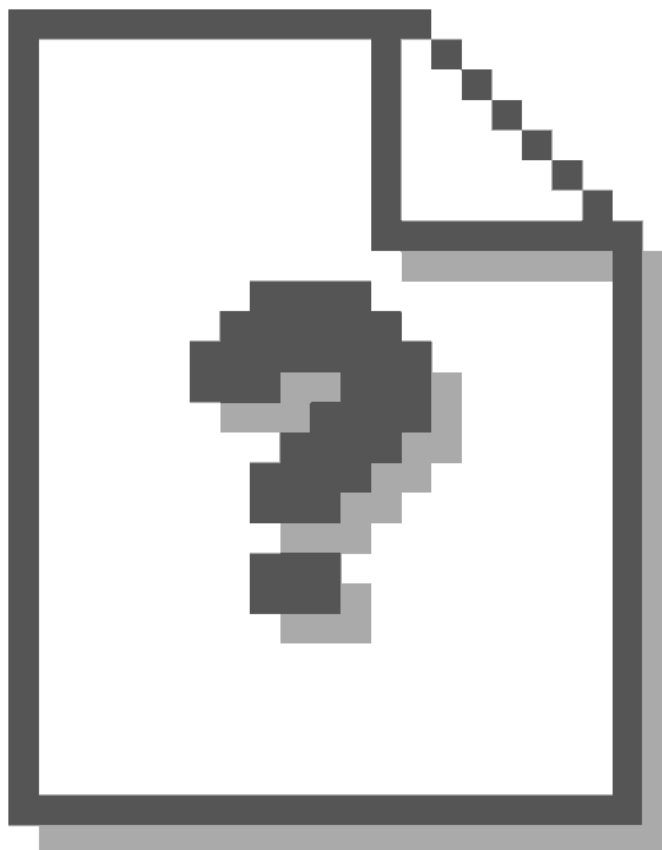
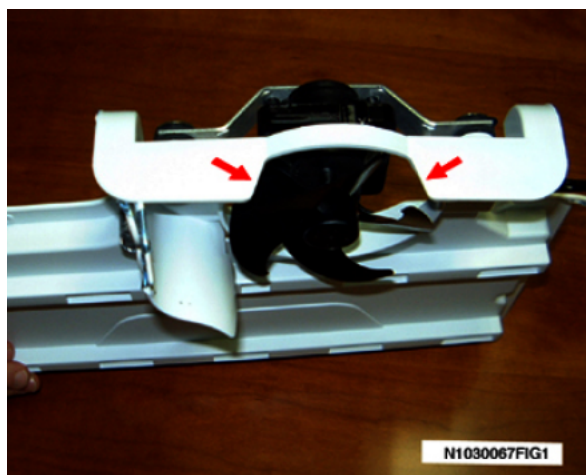

## n1030068: Low fridge compartment temperatures in Ariston and Indesit Opera-60 Total No Fro

In Ariston and Indesit Opera-60 Total No Frost fridge-freezers produced before June 2003, there may be a lowering of the fridge compartment temperature in the crisper area (with freezing of food) due to the backflow of cold air from the freezer.

This problem generally occurs when the "super freezer 24 or 48 hours" function is set.

The problem has been solved as follows:

- 1) The "Super freezer-24 hours" power card software has been modified. The power cards managed as spare parts (095711 - 094383) were all replaced on 01/06/2003.
- 2) The lower vents on the multiflow have been closed from the inside (see fig.3/4-ref.A) and the outlet of those located in the curved area has been reduced (see fig3/4- ref.B). To solve the problem on products in use there are two spare part kits: 094675 for the version with three outlets, and 094737 for that with four.
- 3) The two side sponges on the freezer separator have been lengthened (see fig1-ref. A) and another has been fitted at the back, in the outlet hole area (see fig.1-ref C). Kit 097661 is managed to solve the problem on products in use. This kit includes a double

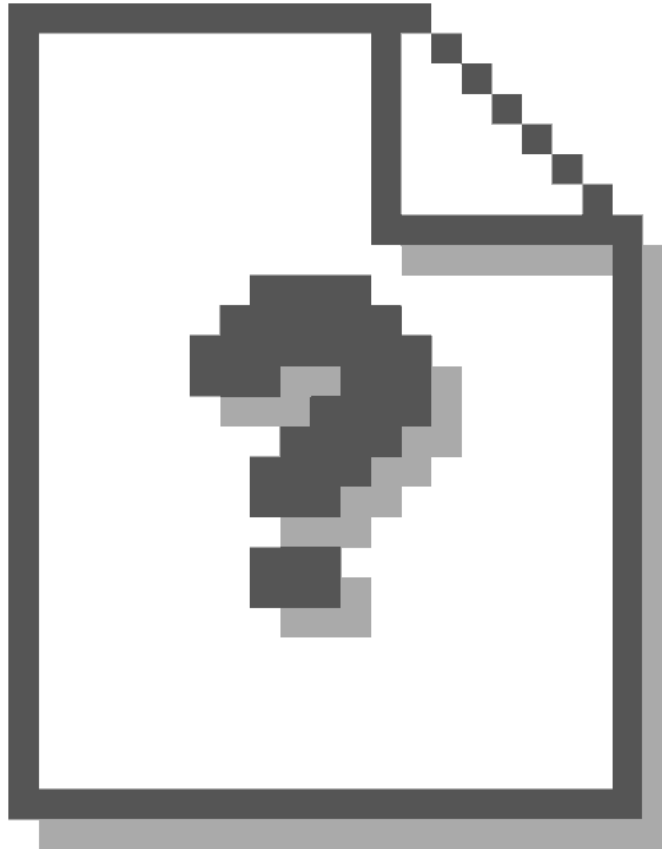

filament resistance (see note N1030069).

4) The air conveyor has been modified to improve air circulation (see N1030067 fig. 2-3). Kit 094490 is managed as a spare part to solve the problem on products in use

The models affected by this problem are all those produced between serial nos. 30523.0001 and 30614.0001 for the card software modification; and between 30523.0001 and 30728.001 for the multiflow modification.



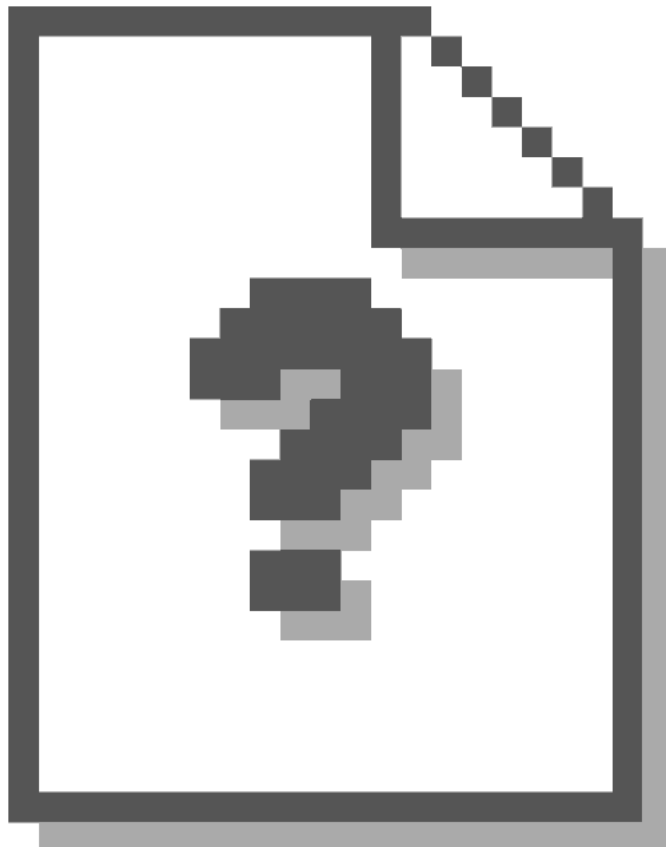
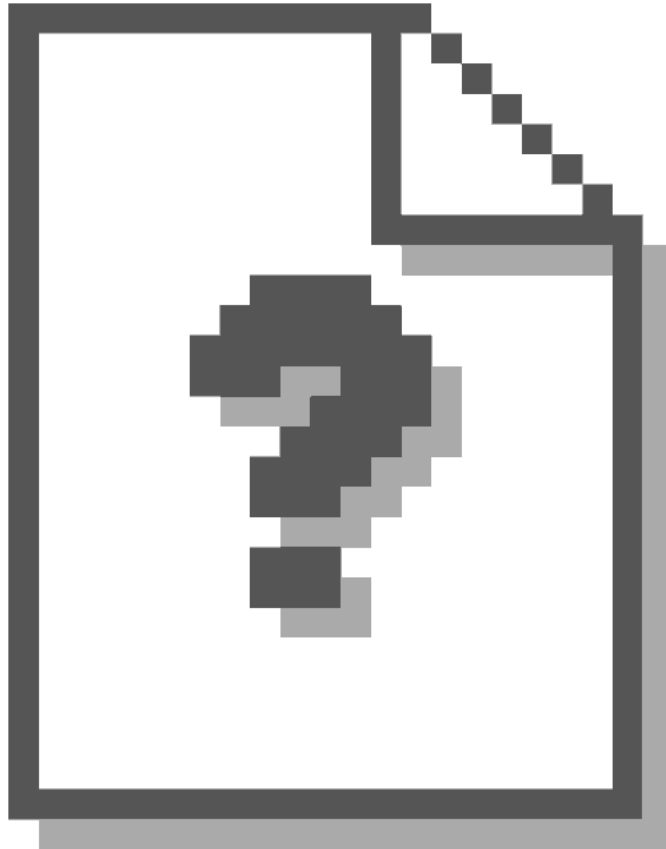



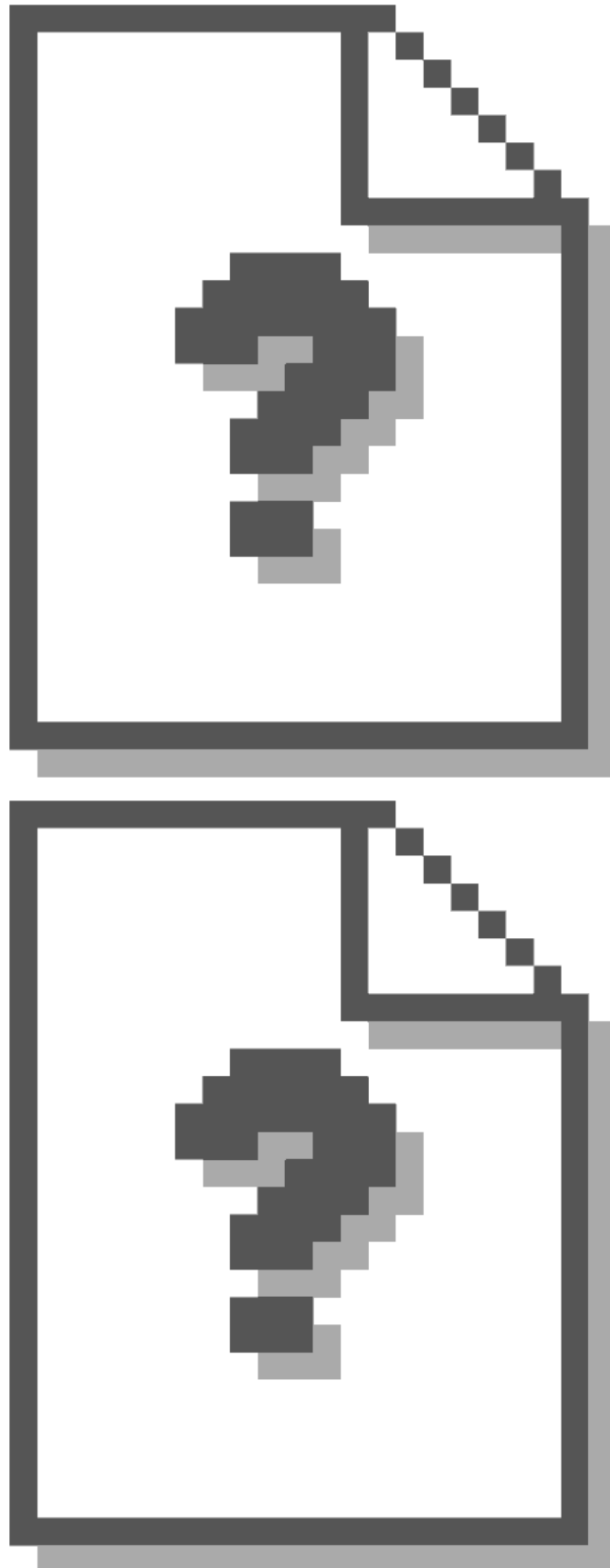

n1030069: Freezer compartment drip hole obstructed on Opera60 Total No Frost fridge-freeze

---

On Ariston and Indesit Opera60 Total No Frost fridge- freezers produced before June 2003, the freezer separator drip hole may

be obstructed due to ice build-up.

The problem has been solved by fitting a double filament resistance at the end part, which can be seen by removing the rubber protection. (see fig. 1). The resistance is glued to the drip (see fig. 2).

Freezer separator Sat code 094485, complete with modified resistance, is managed as a replacement to solve the problem on products in use.

If the 40W resistance needs replacing it will be necessary to restore the sealing, located in the hole area, using silicone (see fig3 - ref A).

Also, to protect the separator from possible water penetration, silicone is used to protect the drip with polystyrene insulation at the back, and also the right corner, relevant to the wiring outlet is protected with silicone in the upper part.

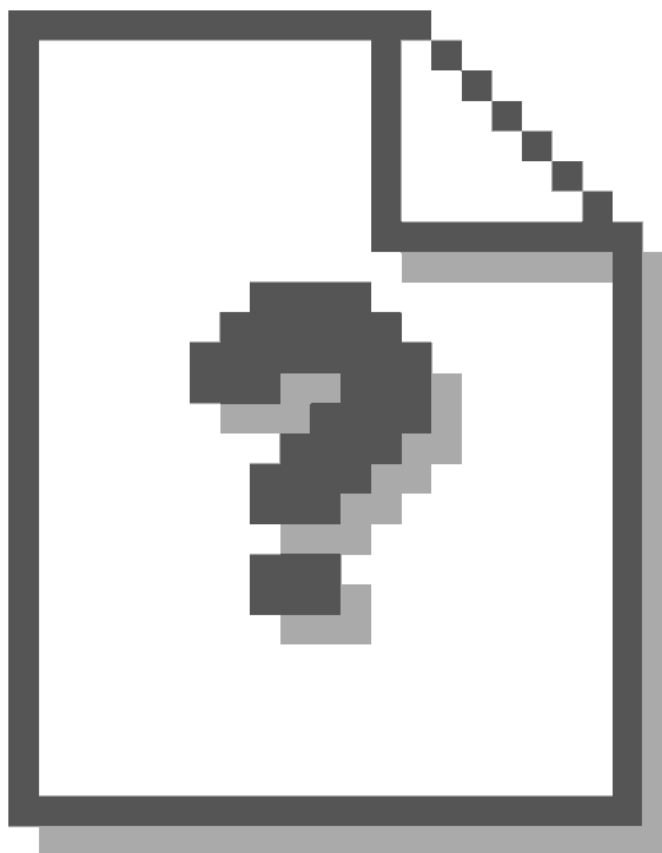

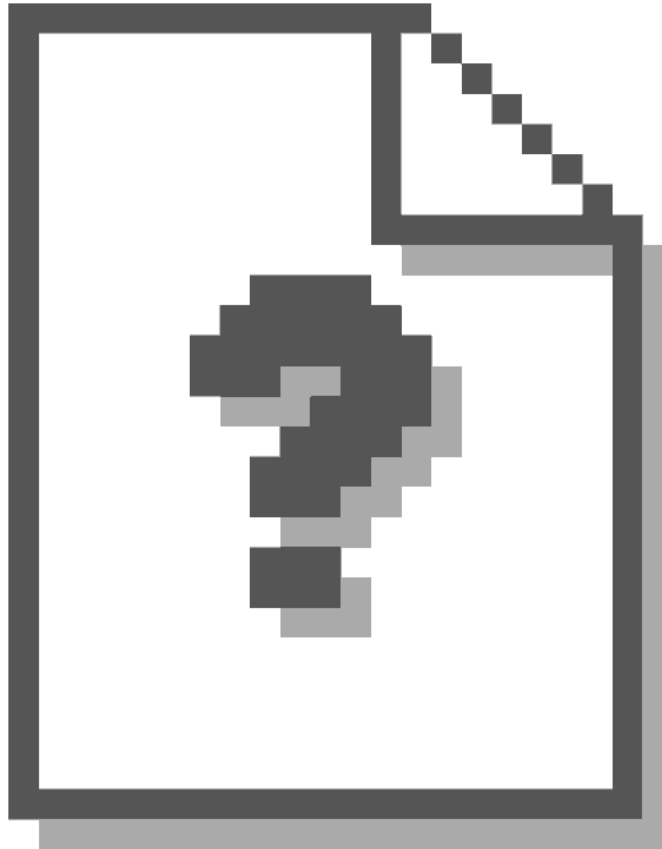

#### n1030079: Modification of multiflow on Ariston and Indesit Opera-60 Total no frost

---

In June 2004 (serial no. 40604.0001), the Melano factory modified the multiflow fixing system to the shell on Ariston and Indesit Opera-60 Total No Frost fridge-freezers.

The inner wall of premodification models featured four square marks (20x20) in the central area for fixing the multiflow cover. The four marks have been eliminated and the wall only features the position for the holes.

Furthermore, the head of the four pins that house the fixing screws on the multiflow cover have been modified. Premodification items ended with an external diameter of 9 mm, whereas the current version has a diameter of 16.3 mm (see figures N1030079FIG1 and FIG2).

The new multiflow cover can be mounted on premodification models but not vice versa, paying attention not to overtighten the screws as the pins may break. If necessary, bush 039567 can be used as stopper.

The multiflow cover is managed as Kit to solve the problem, on products in use, of the formation of condensation on the vegetable basket due to the inflow of cold air from the freezer (see note N1030068).

Spare parts related to the replaced items will be available until stocks run out.

NB- Opera-70 fridge-freezers produced in the Manisa factory are not affected by this modification.

#### New parts

111030 - 4-way multiflow cover KIT (serial no. 40604.0001)

111050 - 3-way multiflow cover KIT (serial no. 40717.0001).

#### Parts replaced

094737 - 4-way multiflow cover KIT

094675 - 3-way multiflow cover KIT

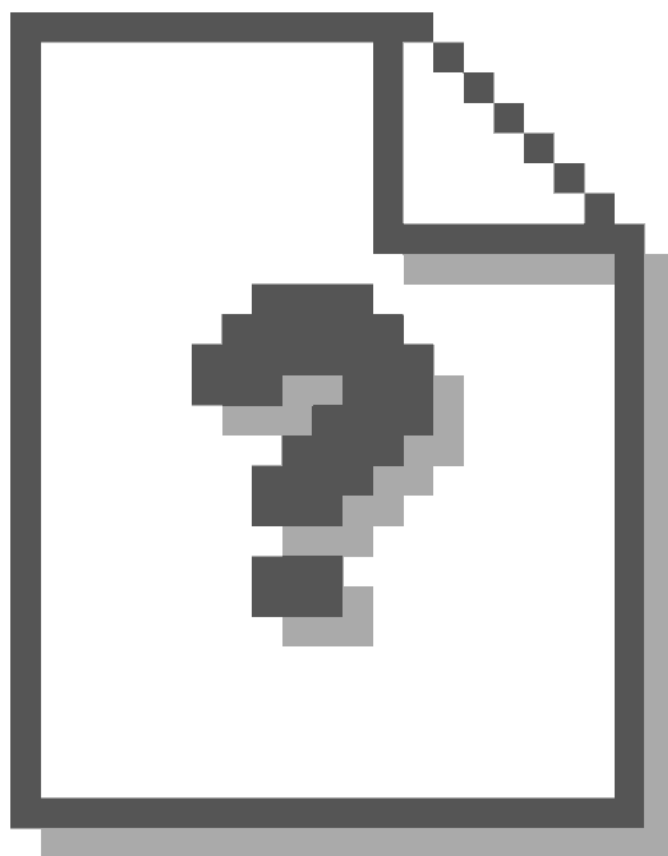

n1030088: Production of Indesit 60 fridge-freezers (2003 restyling) in Polar White colour

---

In January 2005, the Melano factory started producing Indesit fridge-freezers (width 60 cm) in the new "polar white" colour in place of white-27.

The industrial code of these models has changed (see example), whereas the initials (BE33PI) and commercial code (29265) have remained the same.

E.g. 93292650201 = BE33PI white-27

E.g. 93292650301 = BE33PI polar white

The colour change affects the following structural and external appearance parts only:

- Body, body control panel, plinth.
- Central hinge and hinge covers, hole covers.
- Doors, gaskets, handles, control panel, bushes.
- Knobs, control panel button covers.

All internal accessories (racks, profiles, drawers, etc.) and door accessories (door shelves, egg trays, boxes, etc.) have remained the same.

NB- When you order a spare part, please pay attention to the industrial code.

Given below is the list of Polar White models:

93292670301BE34PI  
93292960300BA13FR  
93294970301BA33PI  
93295020301BA34PI  
93296130000B23SP  
93296140000B23VSP  
93296550200BAA13NL  
93296550201BAA13NL  
93296990101B32  
93301930100BA139UK  
93302360100BA13  
93302380100BA137  
93302400200BA14  
93310580200B33FNFP UK  
93310600200B339NFPUK  
93311450201BA13PI  
93321640100BA35FNFPFR  
93321650100BAA17FR  
93321650101BAA17FR  
93322490100B3344FNFPSP  
93328510100BAG18FR  
93328520100BA14FR  
93331120000B3377FNF  
93337820100BA13GFUK  
93337890100BA13GFI  
93338170100BA12UK  
93338180100BA12FR  
93338200000BA12NL  
93338210100BA12  
93338220100B12  
93338230100B13UK  
93338240100B13  
93338250100BA13NL  
93341600100BA34FNFP



## n1030060: Self-test for initialising the new electronic power cards

---

On Ariston-Opera-60/70 and Indesit 2000 range electronic models, including 2000 range built-in fridge-freezers, it is very important to do the self-test whenever the power card is replaced.

This must be done to check correct operation of the card and to correctly initialise the algorithms.

If the SELF-TEST is not carried out on Partial no-frost and Total no-frost (double door or free standing/built-in fridge-freezers) models, the first defrost cycle will not be executed correctly; it will be carried out only 30 days after card replacement.

The list of relevant Sat codes with information sheet for the self-test is attached to this note.

089830 - CARD 4084-02/GREEN 70-nf vfd/fip  
089831 - CARD 4085-02/pink (L70NF 2 digits)  
095779 - CARD (MAGNETEK 4087/GREEN) 220-240/50  
094383 - CARD (MAGNETEK 4088/ORANGE) 220-240/50  
095711 - CARD PANEL.4087/YELLOW DISPLAY VERS.  
089759 - CARD (MAGNETEK 4083/PINK) 220-240/50  
096661 - CARD PANEL. 4068/PURPLE (L70NF ARS/IND.)  
098024 - CARD (MAGNETEK 4083/PINK) 220-240/50 REPLACED

## n1030085: New freezer evaporator on Ariston/Indesit total no frost 60 cm fridge-freezers

---

In October 2004, the Melano factory modified the freezer evaporator and return tube on Ariston and Indesit Opera-60 total no frost fridge-freezers, in order to improve the connection.

Now the return tube is straight (outer diameter 6 mm), whereas previously it had a socket end 15 mm long (outer diameter 6.35 mm).

Before the modification, the coil tube on the freezer evaporator (outer diameter 8 mm) was straight, now it has a tapered end section 15 mm long (outer diameter 7.6 / inner 6.2 mm) to insert the return tube.

If the evaporator needs replacing, it will be necessary to connect it with a Lokring connector 7.5/6 NRAL50 (058213) or 7.5/6NRMS00 (058203).

If tightness is lost when the ring is removed, it will be necessary to use connector 8/6 NRAL50 (058214) or 8/6 NRNS00 (042050).

The new freezer evaporator can be fitted on premodification appliances, but once the ring is removed, the 6 mm outer diameter must be restored on the return tube (check that it is long enough to be able to use the pliers to connect the 7.5/6 ring).

New parts

113845 - NOFROST FREEZER EVAPORATOR ASSEMBLY R600/R134a

Parts replaced

094667 - NOFROST FREEZER EVAPORATOR ASSEMBLY R600/R134a





## Electric schemes and links

Cod. SE109200

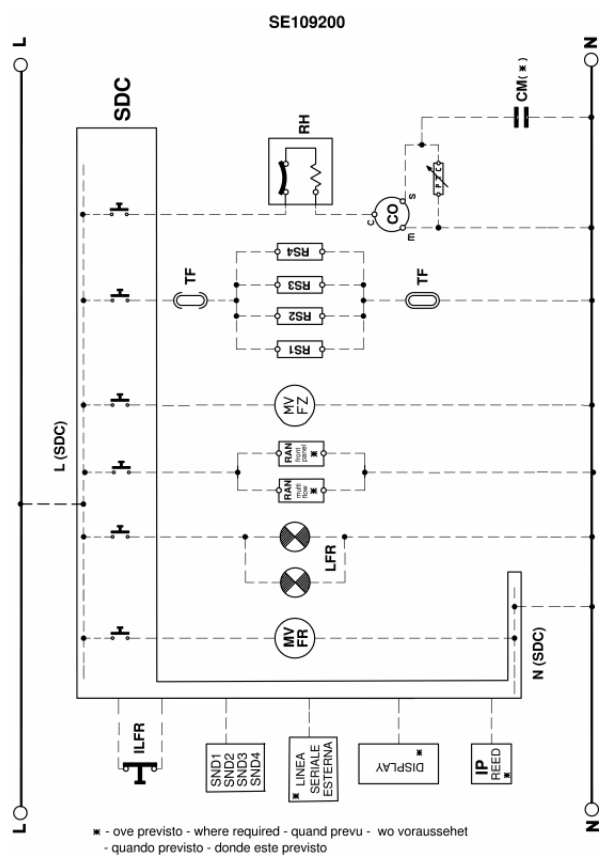

## Legend

Legend: SE109200

BZ	Audio freezer alarm	PTC	PTC relay
C	Surge Capacitor	R	Heating resistance
CM	Running capacitor	RA	Ammetrical relay
CO	Compressor	RAN	Heating element condensation
EV	Electrovalve	RFZ	Heating element condensation freezer
FA	Radio anti-trouble filter	RH	Thermal relay
IDS	Schackler with warning	RS	Defrosting resistance
IEC	ON OFF loads switch	RS1	No frost evaporator resistance
IEFR	ON OFF refrigerator switch	RS2	No frost drip pan resistance
IETH	Thermostat exclusion	RS3	Defrosting resistance
ILFR	Push-button for fridge lamp/fan	RS4	Defrosting resistance
ILFZ	Push-button for freezer lamp/fan	RTA	Thermo actuator defrosting resistance
ILI	Lamp switch	SA	Allarm warning
IP	Door switch	SC	Freezing warning
IR	Line switch	SDC	CONTROL CARD DIAGRAM
ISC	Warning light-freezing switch	SL	Line warning
IV	Fan-motor switch	SND1	SONDE VERDAMPFER KUEHLSCHRANK
IVFZ	Freezer fan-motor switch	SND2	SONDELUFTE FREEZER
L	Line	SND3	AIR-PROBE REFRIGERATOR
LFR	Fridge lamp	SND4	Sonda evaporator freezer
LFZ	Freezer lamp	TA1	Open thermo actuator
LI	Lighting lamp	TA2	Closed thermo actuator
M	Mass/Eart symbol	TC	Turbocooling
MO	Terminal board	TF	Fuse-thermic
MT	Timer motor	THA	Allarm thermostat
MV	Fan motor	THC	Freezer thermostat
MVC	Compressor fan motor	THDF	Refrigerator shackler thermostat
MVCO	Compressor compartment fan	THI	Thermostat switch
MVFR	Fan motor fridge	THR	Adjustable thermostat
MVFZ	Fan motor freezer	TP	Thermoprotector
N	Neutral	TR	Transformer